

USB 3.0 Intraoral Camera

IRIS^{HD}

HIGH DEFINITION

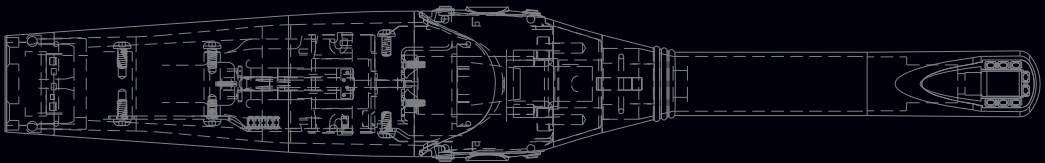

Manual
MA0031
Digital Doc LLC

 **Digital DOC**



Table of Contents

1. Safety Instructions
2. Cautions
3. Important Safeguards
4. System Requirements / Compatible Software
5. IRIS HD Handpiece
6. **The Iris HD** Focus Controls
7. **The Iris HD Handpiece** Sheaths
8. Iris HD Camera Accessories
9. Warranty, Tech Support & Repair Procedures

Safety Instructions



This symbol alerts the user that important literature concerning the operations and maintenance of this unit have been included. Therefore, it should be read carefully in order to avoid any problems.

CAUTION	
	TO REDUCE THE RISK OF ELECTRIC SHOCK, DO NOT REMOVE COVER. NO USER-SERVICEABLE PARTS INSIDE. REFER MAINTENANCE TO QUALIFIED SERVICE PERSONNEL
WARNING	
TO PREVENT FIRE OR ELECTRICAL SHOCK, DO NOT EXPOSE THIS DEVICE TO EXCESSIVE MOISTURE	
WARNING	
THIS DEVICE IS NOT SUITABLE FOR USE IN THE PRESENCE OF A FLAMMABLE ANESTHETIC MIXTURE WITH AIR OR WITH OXYGEN OR NITROUS OXIDE	
	ATMOSPHERIC PRESSURE RANGE: 700-1060 hPa
	Type BF Equipment WATER INGRESS PROTECTION: ORDINARY EQUIPMENT
CAUTION	
CHANGES OR MODIFICATIONS NOT EXPRESSLY APPROVED BY THE MANUFACTURER COULD VOID THE WARRANTY MODE OF OPERATION: CONTINUOUS OPERATION ALTHOUGH THE UNIT WILL GO INTO STANDBY AFTER 20 MIN. OF NON-USE	
ENVIRONMENTAL OPERATING SPECIFICATIONS	
<p>Temperature Range</p> <p>Operating: 10 °C to 40 °C (50 °F to 104 °F)</p> <p>Storage: -40 °C to 70 °C (-40 °F to 158 °F)</p> <p>Relative Humidity</p> <p>Operating: 30% to 75% (non-condensing)</p> <p>Storage: 10% to 100% (non-condensing)</p>	

Cautions

- Federal law restricts this device to sale by or on the order of a Licensed Dental practitioner.

Cautions on Safety

- Be careful not to damage the USB cable. Be sure to hold the plug when disconnecting the cable.
- Do not place a container with water or liquid, or any small metallic objects on this unit. If water, liquid, or any metallic object enters this unit, disconnect the USB cable immediately and contact Digital Doc.
- If smoke, abnormal sound or smell occurs, disconnect the USB cable and contact Digital Doc.
- When the unit is not in use for a long time, disconnect the USB cable.
- Do not apply impacts to this unit

Cautions on Installation

- It is required that this device is plugged into a computer that complies with IEC60601. Medical grade computer.
- Do not install this unit in a poorly ventilated place, a dusty place, an unstable place, or where soot or steam occurs.
- Do not use this unit in high temperatures (higher than 40 degrees C) or at temperatures (lower than 0 degrees C)
- Do not use in surgical theaters in hospitals where safety requirements are different from a standard dental clinic.

Cautions on Cleaning

- Disconnect the USB cable before cleaning.
- Do not wipe the surface using benzene, Dicide, thinner, or gluderaldihyde. As this may degrade the lens, or damage the handpiece material.
- Lightly wipe off dirt on the cover and or lens with a soft cloth (i.e. flannel, 2x2, etc.)

Important Safeguards

Installation

- Read and follow instructions- All of the safety and operating instructions should be read before the intraoral camera is operated. Follow operating and usage instructions.
- Retain instructions - The safety and operating instructions should be retained for future reference
- Heed warnings - Comply with all warnings on the camera and in the operating instructions
- This camera should be operated only from the type of power source indicated. USB 3.0
- Attachments - Do not use attachments unless recommended by the camera manufacturer.
- Do not use this camera near water.

CAUTION

MAINTAIN ELECTRICAL SAFETY. POWER LINE OPERATED EQUIPMENT OR ACCESSORIES CONNECTED TO THIS UNIT SHOULD NOT HAVE BEEN MODIFIED SO AS TO DEFEAT THE SAFETY FEATURES. THIS WILL HELP TO AVOID ANY POTENTIAL HAZARD FROM ELECTRICAL SHOCK OR FIRE. IF IN DOUBT, CONTACT QUALIFIED SERVICE PERSONNEL.

System Requirements and Software Compatibility

IRIS^{HD}
HIGH DEFINITION

Computer system requirements

X86 or X64 Based PC
2 Ghz, 32-bit or 64-bit x86 Multicore
1 GB of RAM minimum 2 GB or above recommended
USB 3.0 interface with high power port
CD-ROM or DVD drive
Imaging Software
Internet connectivity recommended
Microsoft Windows 7 Pro, 32-bit or 64-bit
Microsoft Windows 8 Pro or higher 32-bit or 64-bit

Please refer to our website
www.digi-doc.com
for the latest
system requirements

Please refer to the thumb drive
provided with your camera for
driver installation instructions



Tech Support 1.800.518.1102

IRIS HD Compatible Imaging Software

Apteryx
Dental Master
Dexis
Eaglesoft
Patterson Imaging

Please refer to our website
www.digi-doc.com
for updated compatibility

The IRIS HD Handpiece

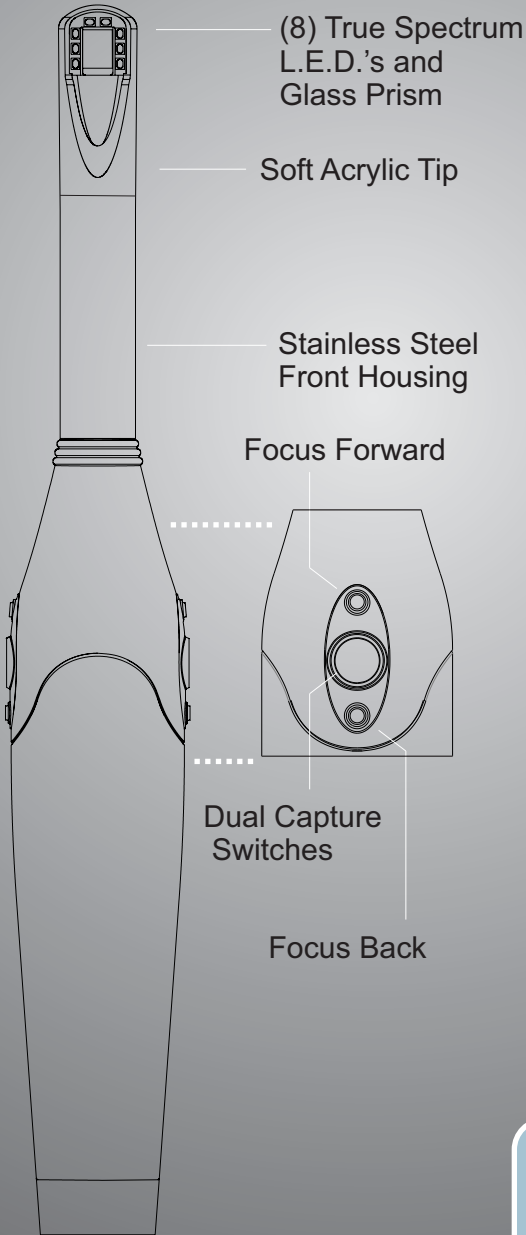

The IRIS HD handpiece is NOT submersible and should be cleaned with an isopropyl alcohol only. Do not use any abrasive cleaners such as Glutaraldehyde or Discide.

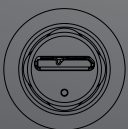
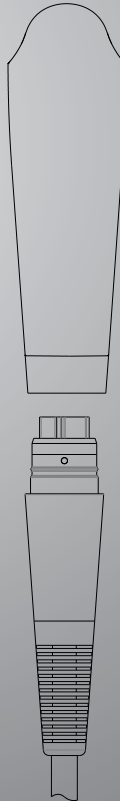

The IRIS HD camera will automatically turn on with movement and shut off after 10 minutes, if left idle.

Focusing the IRIS HD Camera



It is normal for the handpiece to be warm while in use. Heat is a factor in any electronic device. The IRIS HD camera will automatically shut off after 10 min of no movement.

Focus Positions

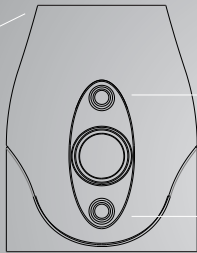
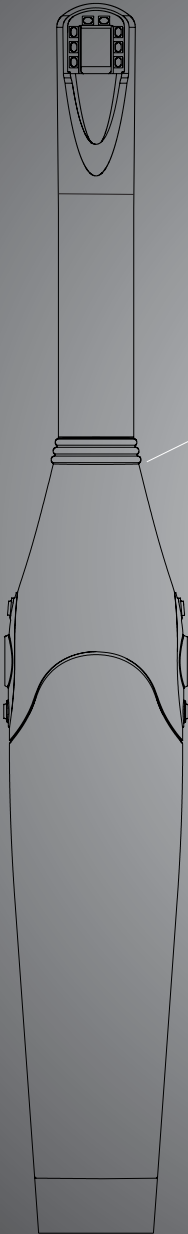

Focus Forward

Focus Back

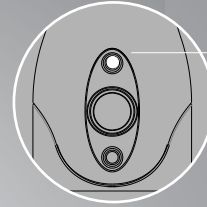

Second Click

Position **M**
Macro

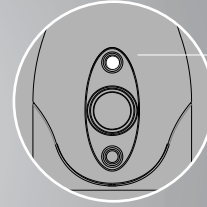

First Click

Position **1**
1 Surface

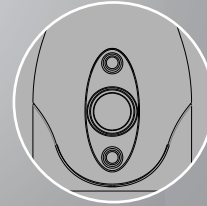

Position **2**
2 Surface
(Home)

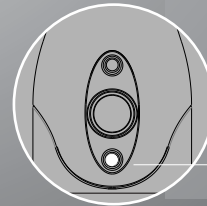

Position **S**
Smile

First Click

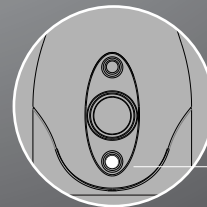

Position **F**
Full Face

Second Click

Each time the camera is turned on, the Focus will reset to the Position 2 (Home) setting. The Focus setting will be displayed on the monitor. Each press of the Forward button will zoom in on the object. Each press of the back button will zoom out from the object.

The IRIS HD Sheaths

The IRIS HD camera will come with a sample pack of sheaths. These sheaths are designed for intra-oral use only.



When applying the sheaths, slide the handpiece with the LED's facing down under the white flap. Push the handpiece in until the end of the sheath is taut, then peel away the top blue layer and the bottom paper layer. It is recommended that you use the bottom paper layer, or a gloved hand, to press the sheath against the lens for approximately 3 seconds.

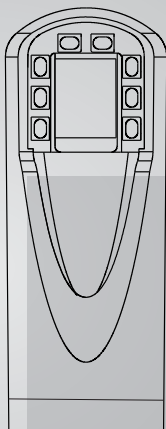
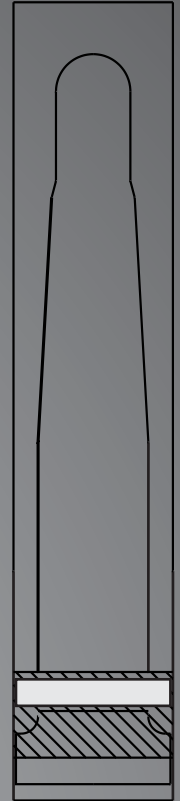
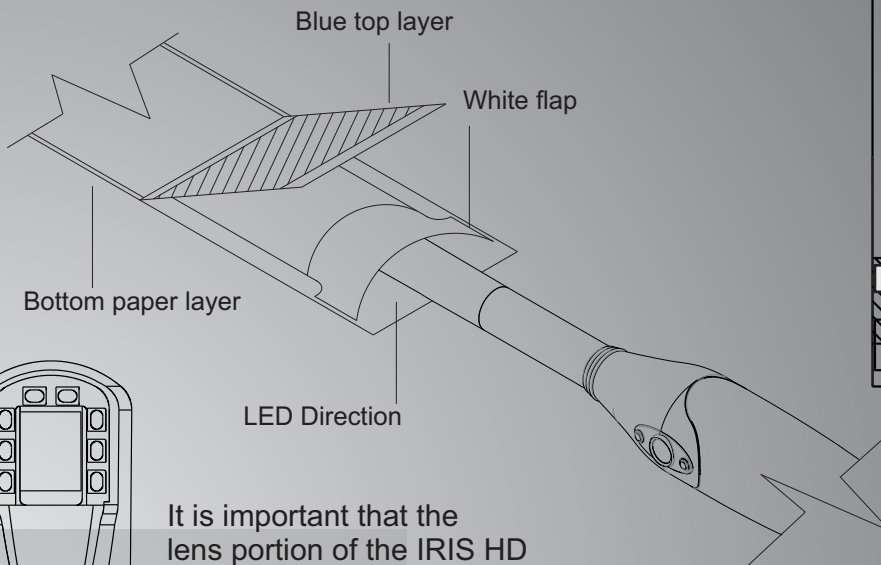
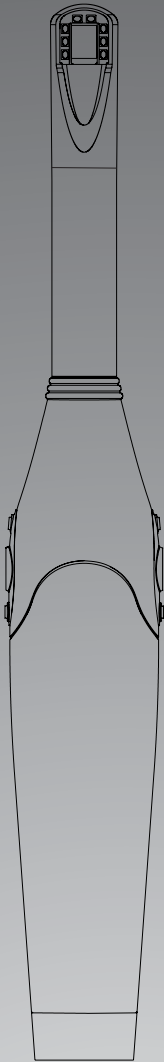

It is important that the lens portion of the IRIS HD camera not be cleaned with any abrasive materials and or chemicals



IRIS HD Camera Accessories

IRIS^{HD} HIGH DEFINITION

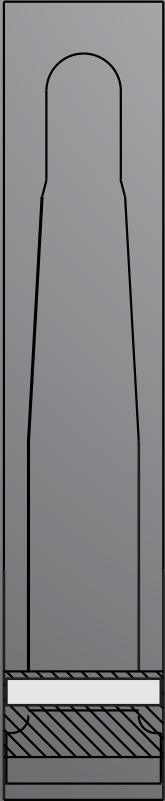

Protective Sleeves
1 Box (500 units)
Part Number
SH0007

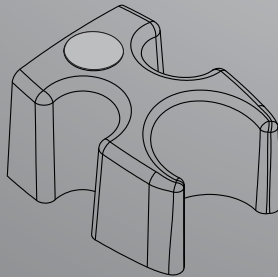

Handpiece Cradle
Part Number
AS0125

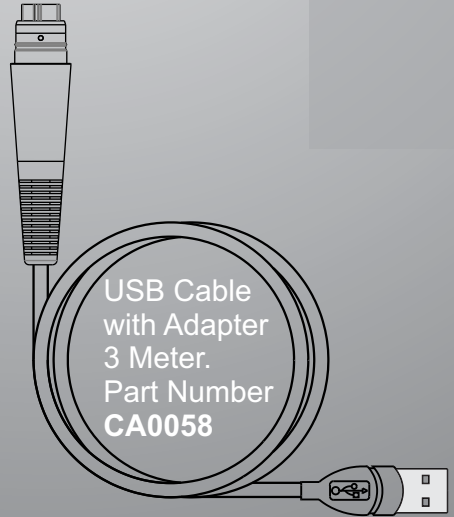

USB Cable
with Adapter
3 Meter.
Part Number
CA0058



DigiWipe
Camera Cleaners
Part Number
SH0005

Warranty, Tech Support & Repair Procedures

Digital Doc Provides Free
Technical Support
at 1.800.518.1102

LIMITED WARRANTY & RETURN POLICY FOR DIGITAL DOC LLC

Digital Doc LLC agrees to guarantee each IRIS or IRIS HD camera to be free from manufacturer defects for the term of two years from the date of purchase, when used in accordance with manufacturer's instructions. In the event a product is returned by the dealer, or the end user, and the warranty has expired, Digital Doc LLC reserves the right to collect a reasonable fee from the end user for services mutually agreed upon.

Digital Doc LLC does agree to replace any defective product, for any reason, free of charge, during the first ninety (90) days from the date of purchase. After the first ninety (90) days, Digital Doc LLC, will repair under warranty for manufacturer defects only and pay the shipping to return the repaired item to the customer. The customer will be responsible for shipping charges to Digital Doc. If the customer elects to ship the product three-day economy, Digital Doc LLC, will return-ship in the same manner. Further, if the customer elects to ship the product overnight, Digital Doc LLC will reciprocate in the same manner.

Misused, abused or dropped cameras only covered under this warranty for the first 90 days from date of purchase. After the first 90 days they will be billed for parts and labor.

Digital Doc LLC will require the end user to phone the Technical Service Department at 800.518.1102. Please have your camera serial number ready prior to contacting Technical Support. Once the cause of the failure has been determined, Digital Doc LLC will issue a "Return Merchandise Authorization" (RMA) number to be written clearly on the outside of the package in which the item is shipped. Items shipped to Digital Doc LLC without the RMA written on the outside of the package will be returned to the customer at their cost. No items will be received for warranty or non-warranty work without the RMA number printed clearly on the package. All non-warranty repairs will need a credit card, or some form of payment prior to the repair work being authorized.

If your repair is deemed under warranty, Digital Doc LLC agrees to repair or replace the item, at Digital Doc's discretion. The item will then be shipped to the person, or persons whose name appears on the shipping label. All non-warranty repairs will be billed at \$135.00 per hour plus parts. **All refusals to authorize non-warranty work will be subject to a one-hour minimum charge.**

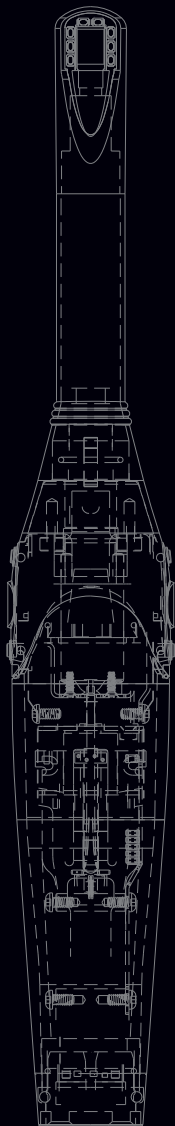

IIRIS^{HD}

HIGH DEFINITION

Digital Doc LLC
4789 Golden Foothill Parkway
El Dorado Hills, CA. 95762
1.800.518.1102
www.digi-doc.com